



SOAPSTONE

ESTATES



Ranch

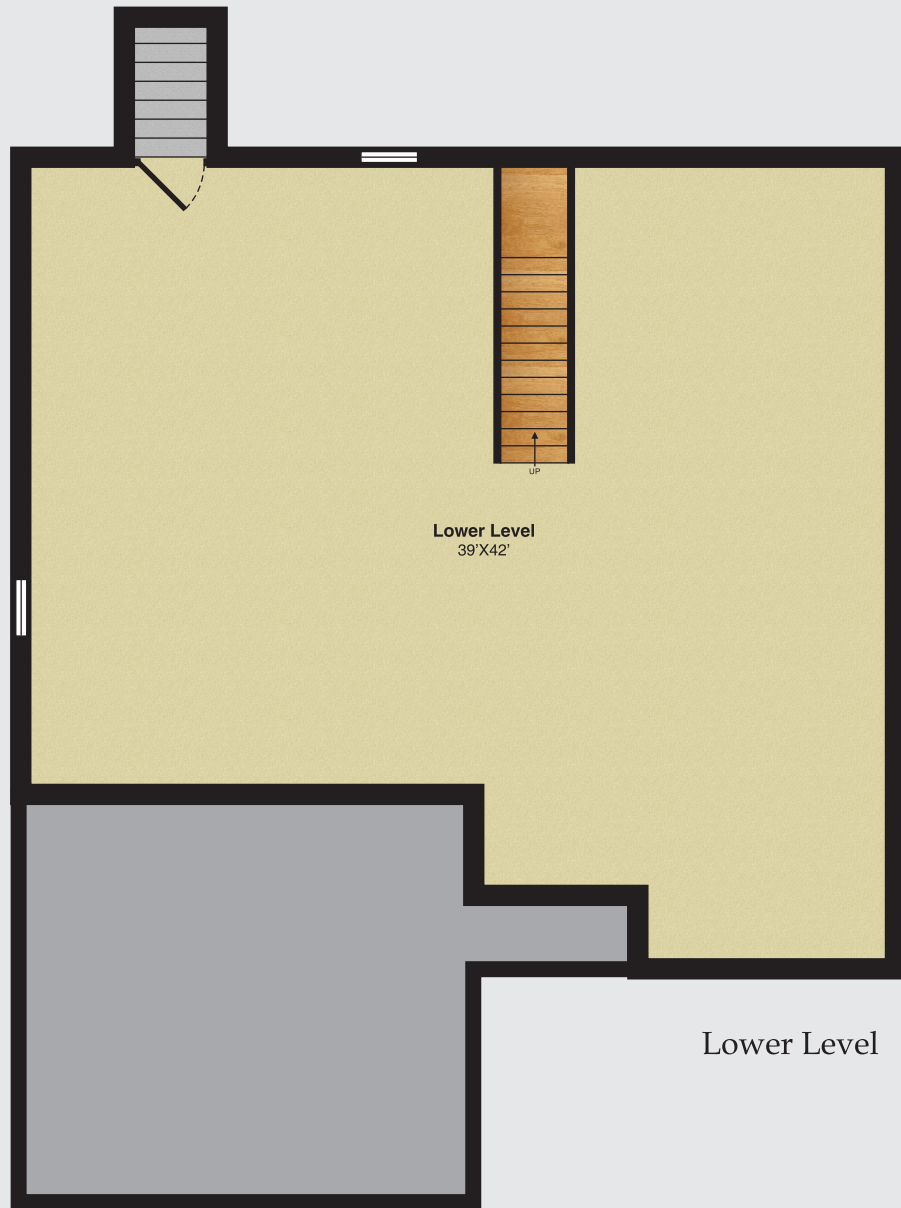

Lower Level



First Floor



COLDWELL BANKER
NEW HOMES



Although all illustrations, specifications and dimensions are believed correct at the time of publication, accuracy cannot be guaranteed. The right is reserved to make changes without notice or obligation. Windows, doors and ceilings may vary on the options and elevations selected. Optional items indicated are available at additional cost. This brochure is for illustrative purposes only and not part of a legal contract. See Sales Representative for details. Coldwell Banker has Ownership of all Artwork including original digital files as well as preliminary designs. Artwork cannot be used without written permission of Coldwell Banker.



SOAPSTONE

ESTATES



Ranch Duplex

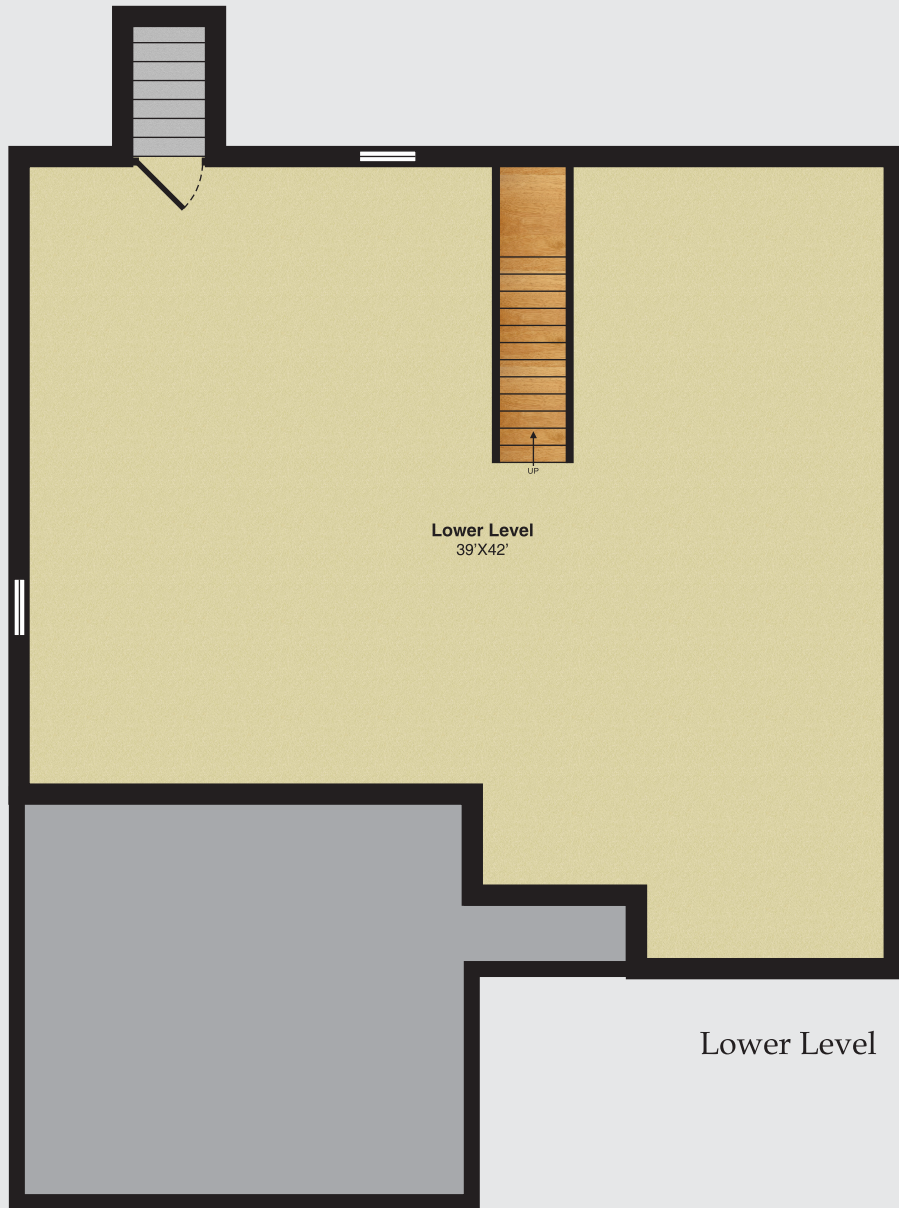

Left Unit Shown. Right unit is mirrored.



Although all illustrations, specifications and dimensions are believed correct at the time of publication, accuracy cannot be guaranteed. The right is reserved to make changes without notice or obligation. Windows, doors and ceilings may vary on the options and elevations selected. Optional items indicated are available at additional cost. This brochure is for illustrative purposes only and not part of a legal contract. See Sales Representative for details. Coldwell Banker has Ownership of all Artwork including original digital files as well as preliminary designs. Artwork cannot be used without written permission of Coldwell Banker.

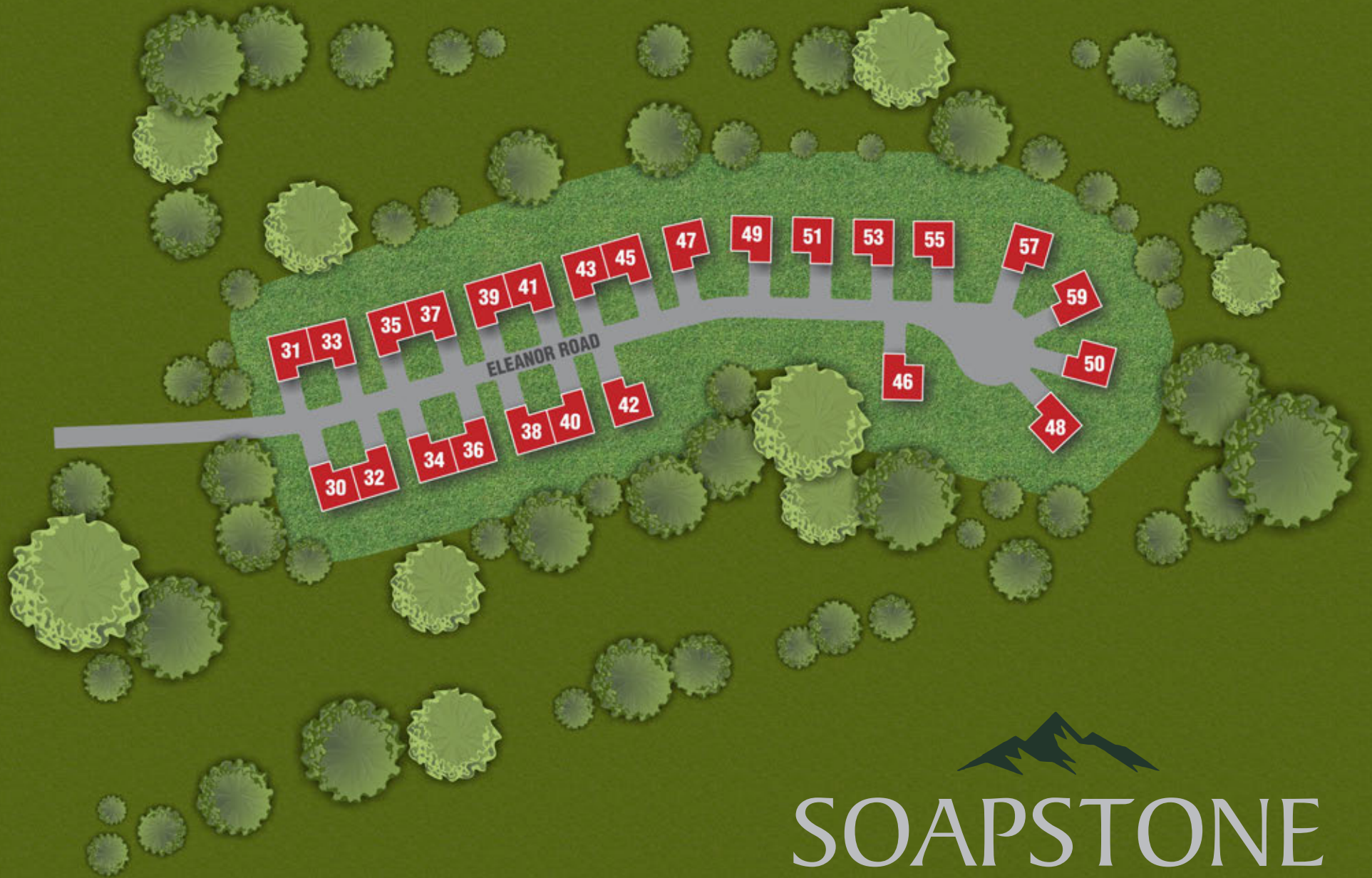

SOAPSTONE

ESTATES



SOAPSTONE

ESTATES

EXTERIOR

- Easy Maintenance Vinyl Siding (Choice of Colors)
- GAF Timberline Architectural Roof Shingles with 30-Year Warranty
- Simonton Tilt-Wash Insulated Windows with Grills and Screens
- Decorative Glass Therma-Tru Raised Panel Insulated Entrance Door with Sidelight
- Seamless High-Capacity Aluminum Gutters and Downspouts
- 12" Overhang with Easy Maintenance Vinyl Trim Components
- 2 Weatherproof Electrical Outlets (front and back)
- Two (2) Exterior No-Freeze Hose Bibs
- Front Entry Concrete Sidewalk
- Steel Insulated 7' High Garage Door with Opener and Remote
- 12'x12' Concrete Patio
- Steel Bilco Double Door and Pre-cast Hatchway
- Colonial Front Yard Lantern with Post (with Auto Dusk/Dawn Sensor)
- Attractive Landscape Plan to include Foundation Plantings with Mulch Beds

INTERIOR

- Spacious 8' Ceiling Heights
- Choice of Flooring - Including Hardwood, Carpet, Ceramic Tile and Vinyl (\$7 sq.ft. Allowance)
- Extra Wide Estate Series Colonial Molding and Trim
- Decorative Schlage Front Door Entry Handle with Deadbolt (option of Brass or Brushed Nickel)

- Therma-Tru 3' Glass Rear Entry Door
- Jeld-Wen Colonial Interior Doors (Various Styles to choose from)
- Lighting (\$1,000 Allowance)

KITCHEN

- Kemper Cabinets (Choice of Finishes and Door Styles)
- Choice of Granite Countertops (12 Colors to choose from)
- Pantry in Kitchen
- Appliance Package (\$4,000 Allowance)
- Choice of Stainless Undermount Kitchen Sink
- American Standard Stainless High Arc Faucet with Pull Down Sprayer

ALL BATHS

- Kemper Vanities (Choice of Finishes and Door Styles)
- Choice of Granite Countertops (4 Colors to choose from) with Undermount Sink
- Easy Care One Piece MAAX Shower Stall and Tub
- American Standard Elongated Comfort Height Slow Close Commodes
- American Standard Edgemere Chrome Faucets
- Low Noise Bath Exhaust Fan

ELECTRICAL

- Hard Wired Smoke and CO Alarms
- 100 Amp Electrical Service with Circuit Brakers

UTILITIES and MECHANICALS

- High Efficiency Central Cooling System
- State of the Art Ruud Propane Heating System with Filtration
- Public Water and Septic Utilities (all underground utility service)

EXTERIOR OPTIONS & UPGRADES

- Stone Veneer
- Full Glass Storm Door
- Decorative Brick Paver Rear Patio
- Trex Easy Maintenance Deck with Matching Rails
- Four Season Sunroom
- Screen Porch
- Covered Deck



COLDWELL BANKER
NEW HOMES

For more information, please contact

Jody Cox
(860) 930-0681 Cell
Enfield Office (860) 745-3345